

ORDINANCE NO. 696

AN ORDINANCE OF THE CITY OF WEEPING WATER, CASS COUNTY, NEBRASKA TO VACATE "Q" STREET BETWEEN S. ELM STREET AND S. RANDOLPH STREET AS DESCRIBED BELOW; SUBJECT TO THE RESERVATION OF A UTILITY EASEMENT FOR THE BENEFIT OF THE CITY OF WEEPING WATER OR ALL OTHER UTILITIES; TO PROVIDE FOR OWNERSHIP OF THE SAME TO REVERT TO THE ADJACENT PROPERTY OWNERS; TO REPEAL ALL ORDINANCES IN CONFLICT; TO PROVIDE FOR PUBLICATION IN PAMPHLET FORM; AND TO PROVIDE AN EFFECTIVE DATE.

BE IT ORDAINED BY THE MAYOR AND CITY COUNCIL OF THE CITY OF WEEPING WATER, NEBRASKA:

Section 1. "Q" Street IN THE City of Weeping Water, Cass County, Nebraska is vacated as generally depicted on the attached Exhibit and described as follows:

From the point of beginning at the southwest corner of Lot 5R, Blk 2 Stander's Subdivision; thence south to the northwest corner of Lot 8, Blk 7, Carter's Addition; thence east to the northeast corner of Lot 1, Blk 7 Carter's Addition; thence north to the southeast corner of Lot 4, Blk 2 Stander's Subdivision; thence west to the point of beginning, all located in the City of Weeping Water, Cass County, Nebraska.

Section 2. The City retains a utility easement over the vacated street for the benefit of itself and all other utilities.

Section 3. That ownership of the vacated street revert to the adjacent property owners from the centerline of the vacated street.

Section 4. All previous ordinances or parts of ordinances in conflict are repealed.

Section 5. This ordinance is adopted in pamphlet form.

Section 6. This ordinance shall be in full force from and after its passage, approval, and

publication or posting as required by law.

PASSED AND APPROVED this 5TH day of February 2025.

Michael Barrett

Michael Barrett, Mayor

ATTEST:

Linda Sheehan

Linda Sheehan, City Clerk

Publication or Posting Date: February 6, 2025.

Cass County GIS

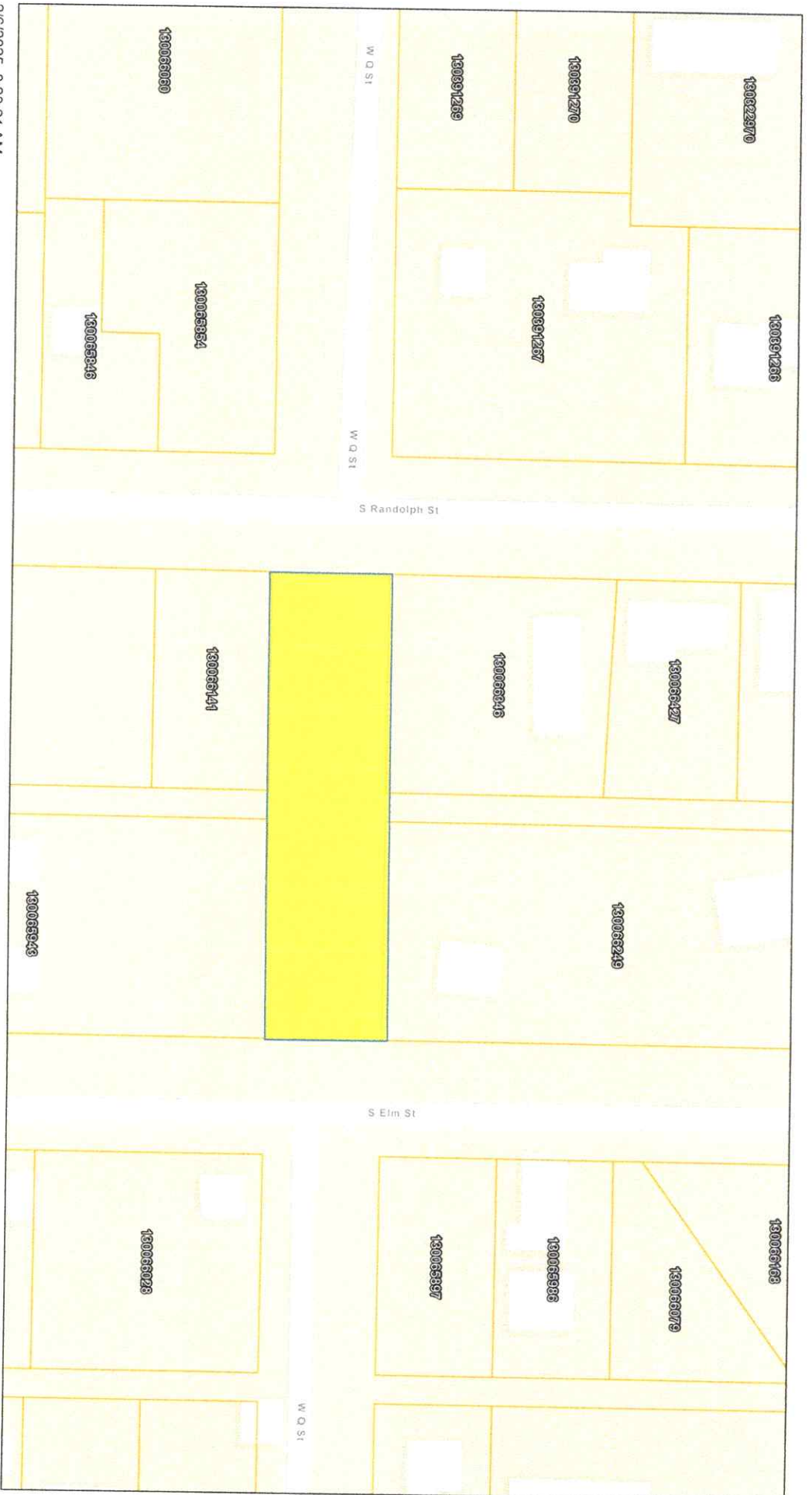

2/6/2025, 8:23:21 AM



 Esri Community Maps Contributors, Iowa DNR, Nebraska Game & Parks Commission, OpenStreetMap, Microsoft, Esri, TomTom, Garmin, SafeGraph, Geotechnologies, Inc, METI/NASA, USGS, EPA, NPS, US Census Bureau, USDA, USFWS